

COUNTY OF WARNER NO. 5 LAND USE DISTRICTS MAP A

LAND USE DISTRICTS

Bylaw No: 930-17

October 24, 2017

Amended to and Including Bylaw 989-24

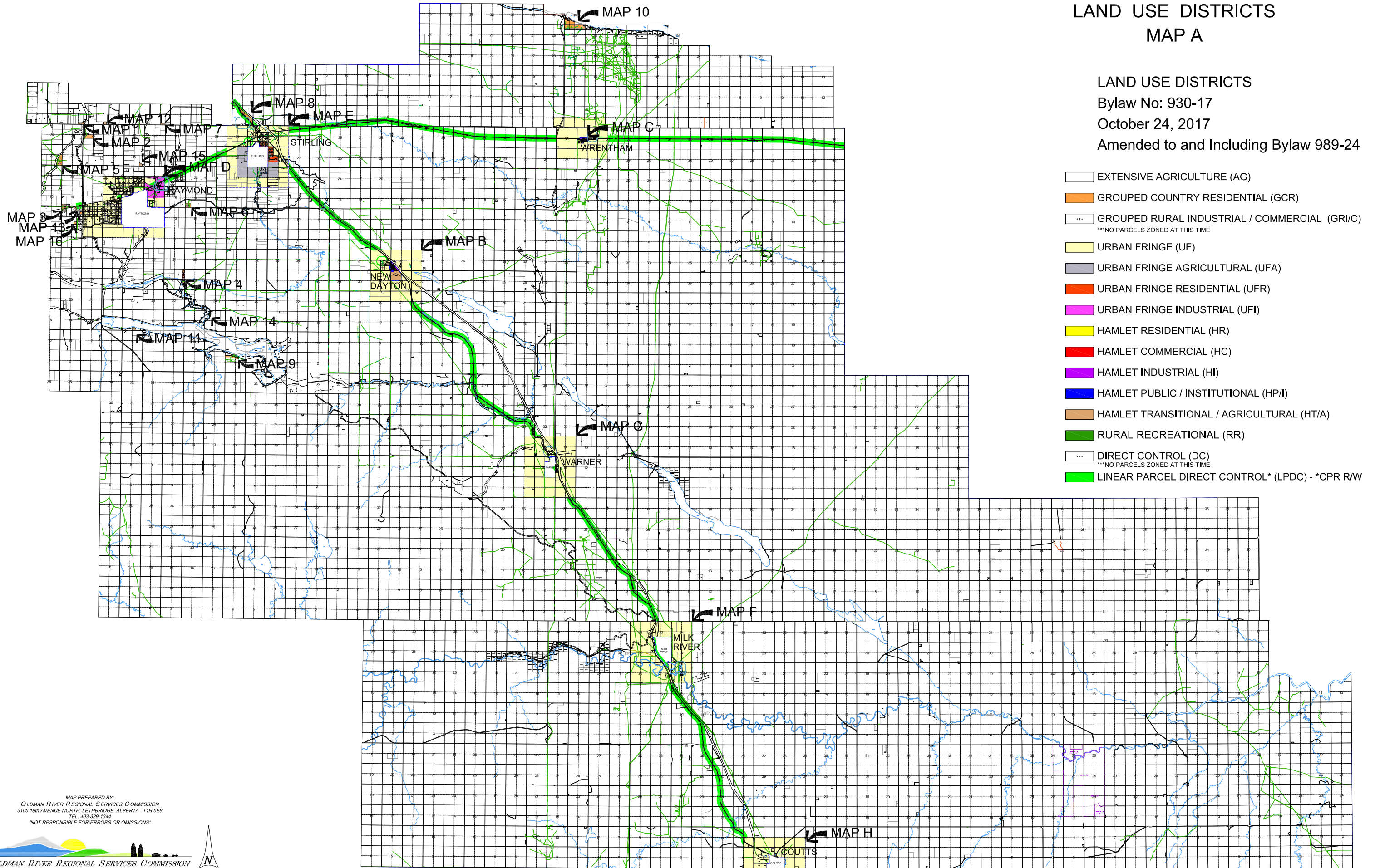

- EXTENSIVE AGRICULTURE (AG)
- GROUPED COUNTRY RESIDENTIAL (GCR)
- GROUPED RURAL INDUSTRIAL / COMMERCIAL (GRI/C)
***NO PARCELS ZONED AT THIS TIME
- URBAN FRINGE (UF)
- URBAN FRINGE AGRICULTURAL (UFA)
- URBAN FRINGE RESIDENTIAL (UFR)
- URBAN FRINGE INDUSTRIAL (UFI)
- HAMLET RESIDENTIAL (HR)
- HAMLET COMMERCIAL (HC)
- HAMLET INDUSTRIAL (HI)
- HAMLET PUBLIC / INSTITUTIONAL (HP/I)
- HAMLET TRANSITIONAL / AGRICULTURAL (HT/A)
- RURAL RECREATIONAL (RR)
- DIRECT CONTROL (DC)
***NO PARCELS ZONED AT THIS TIME
- LINEAR PARCEL DIRECT CONTROL* (LPDC) - *CPR R/W

MAP PREPARED BY:
OLDMAN RIVER REGIONAL SERVICES COMMISSION
3105 16th AVENUE NORTH, LETHBRIDGE, ALBERTA T1H 5E8
TEL. 403-329-1344
"NOT RESPONSIBLE FOR ERRORS OR OMISSIONS"



July 25, 2024 N:\Warner-County\Warner-County LUD & Land Use Redesignations\Warner County LUB 930-17 October 24 2017 (Maps amended To Bylaw 989-24).dwg

COUNTY OF WARNER NO. 5 LAND USE DISTRICTS MAP A-LPDC

LAND USE DISTRICTS
Bylaw No: 930-17
October 24, 2017

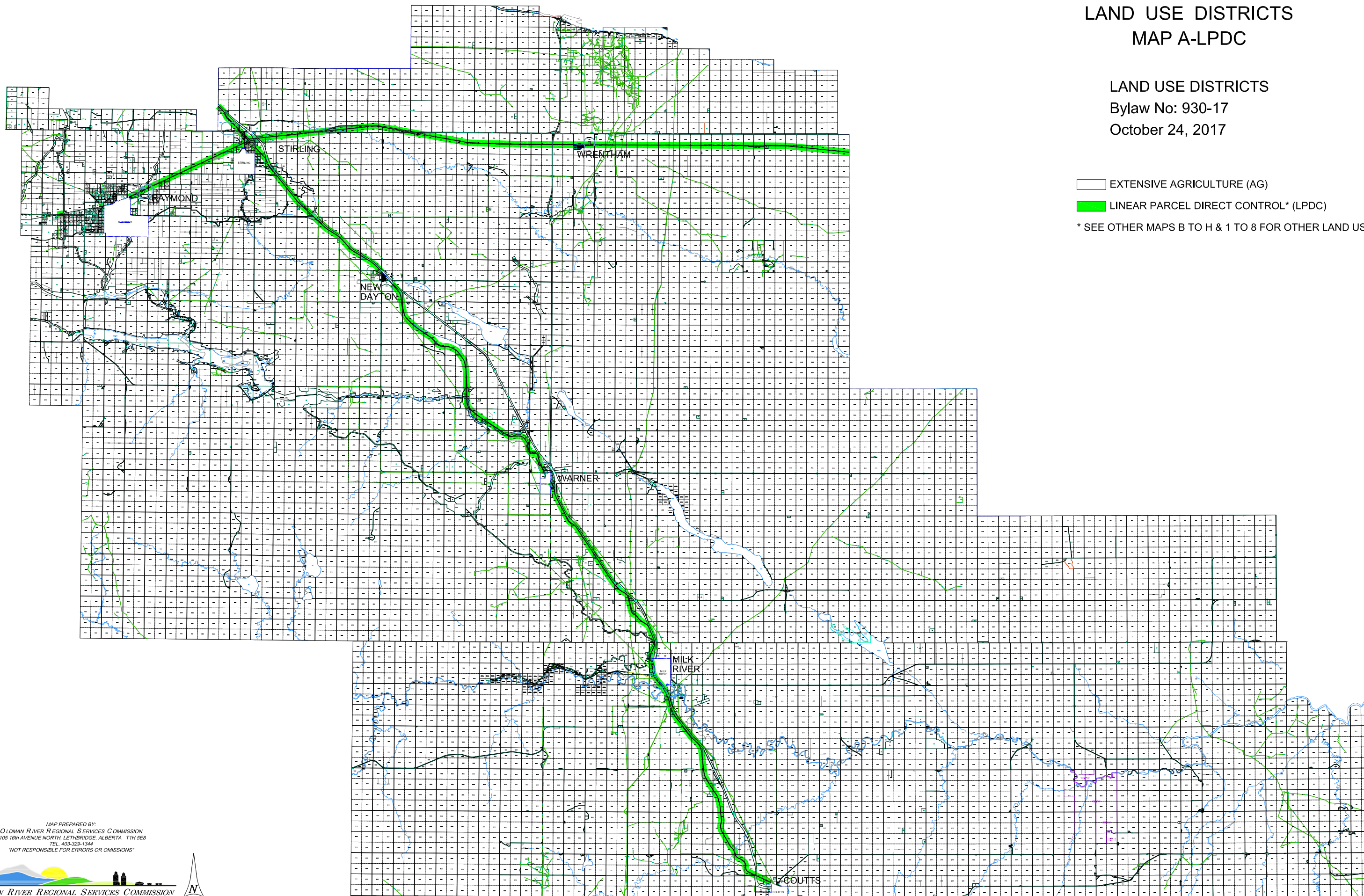

- EXTENSIVE AGRICULTURE (AG)
 - LINEAR PARCEL DIRECT CONTROL* (LPDC) *CPR R/W
- * SEE OTHER MAPS B TO H & 1 TO 8 FOR OTHER LAND USE DISTRICTS









MAP PREPARED BY:
OLDMAN RIVER REGIONAL SERVICES COMMISSION
3105 16th AVENUE NORTH, LETHBRIDGE, ALBERTA T1H 5E8
TEL. 403-329-1344
"NOT RESPONSIBLE FOR ERRORS OR OMISSIONS"

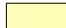

COUNTY OF WARNER NO. 5
 LAND USE DISTRICTS
 MAP B

DESIGNATED HAMLET OF
 NEW DAYTON - FRINGE

LAND USE DISTRICTS
 Bylaw No: 930-17
 October 24, 2017

-  EXTENSIVE AGRICULTURE (AG)
-  URBAN FRINGE (UF)
-  HAMLET COMMERCIAL (HC)
-  HAMLET INDUSTRIAL (HI)
-  HAMLET PUBLIC/INSTITUTIONAL (HP/I)
-  HAMLET RESIDENTIAL (HR)
-  HAMLET TRANSITIONAL/AGRICULTURAL (HT/A)
-  LINEAR PARCEL DIRECT CONTROL (LPDC)
-  HAMLET BOUNDARY

MAP PREPARED BY:
 OLDMAN RIVER REGIONAL SERVICES COMMISSION
 3105 16th AVENUE NORTH, LETHBRIDGE, ALBERTA T1H 5E8
 TEL. 403-329-1344
 "NOT RESPONSIBLE FOR ERRORS OR OMISSIONS"



November 08, 2017 N:\Warner-County\Warner-County LUD & Land Use Redesignators\Warner County LUB 930-17 October 24 2017 (Map).dwg



MAP B-UF

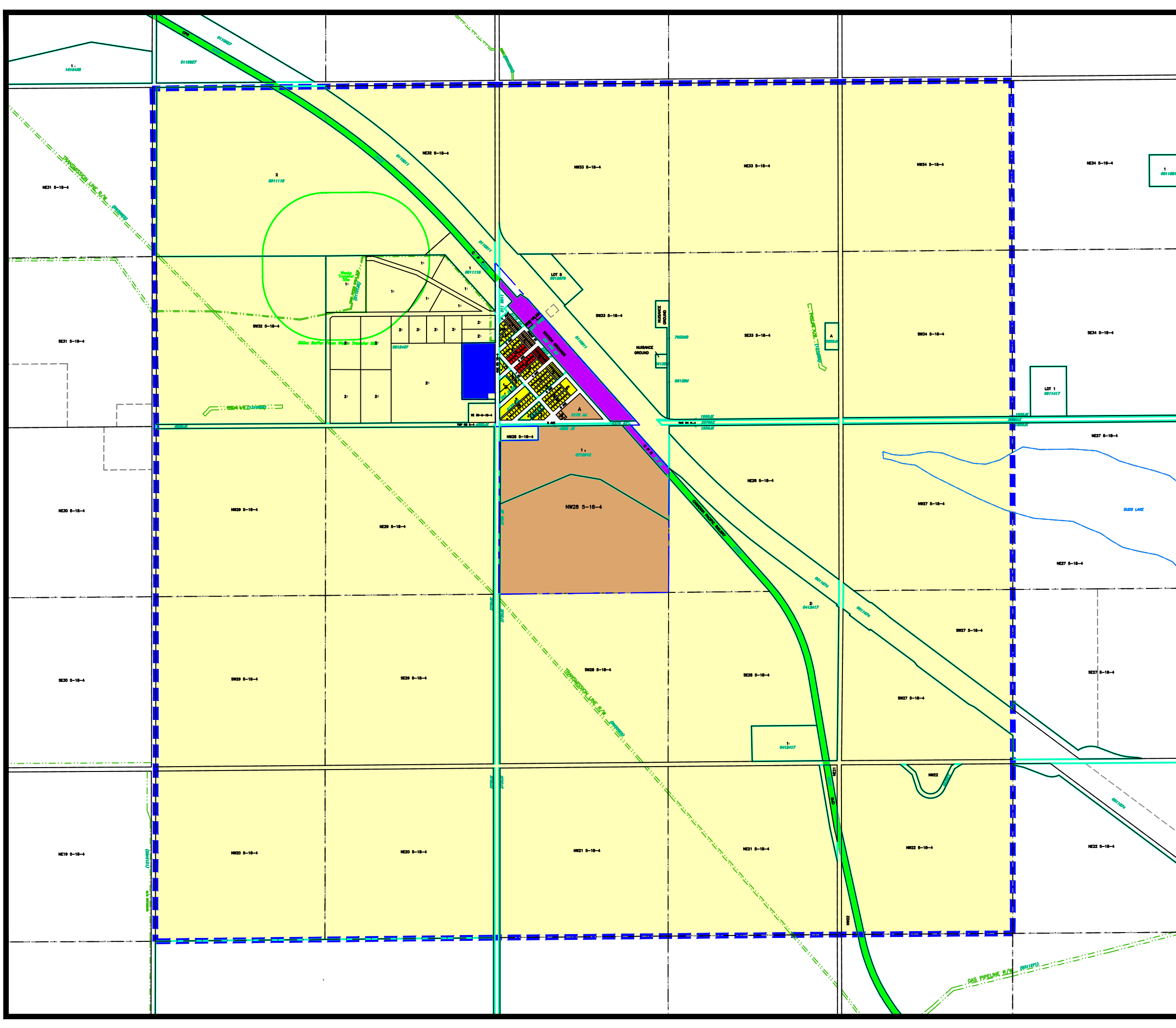

COUNTY OF WARNER NO. 5
 LAND USE DISTRICTS
 MAP B

DESIGNATED HAMLET OF
 NEW DAYTON

LAND USE DISTRICTS
 Bylaw No: 930-17
 October 24, 2017

- EXTENSIVE AGRICULTURE (AG)
- URBAN FRINGE (UF)
- HAMLET COMMERCIAL (HC)
- HAMLET INDUSTRIAL (HI)
- HAMLET PUBLIC/INSTITUTIONAL (HP/I)
- HAMLET RESIDENTIAL (HR)
- HAMLET TRANSITIONAL/AGRICULTURAL (HT/A)
- LINEAR PARCEL DIRECT CONTROL (LPDC)
- HAMLET BOUNDARY

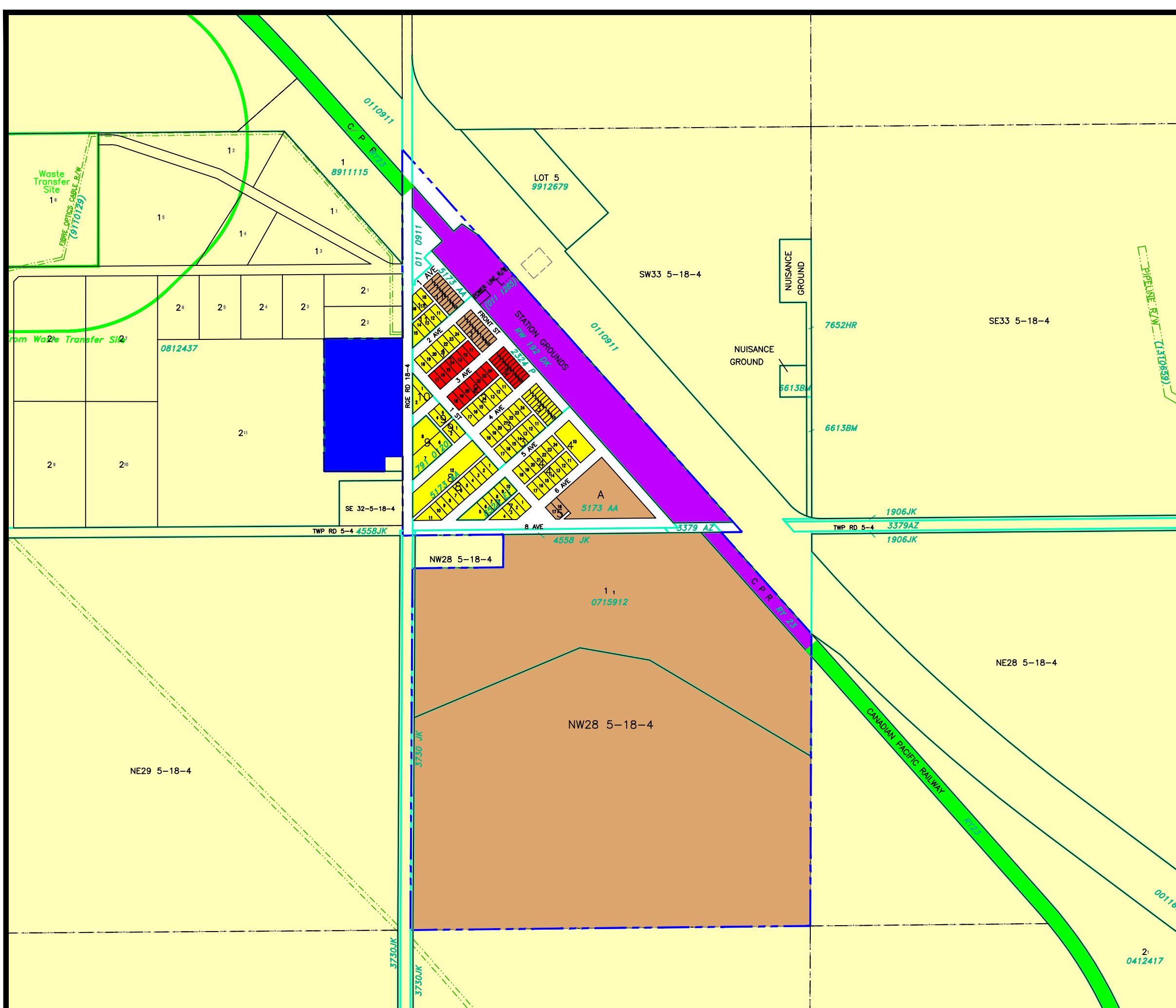









MAP PREPARED BY:
 OLDMAN RIVER REGIONAL SERVICES COMMISSION
 3105 16th AVENUE NORTH, LETHBRIDGE, ALBERTA T1H 5E8
 TEL. 403-328-1344
 "NOT RESPONSIBLE FOR ERRORS OR OMISSIONS"



COUNTY OF WARNER NO. 5
 LAND USE DISTRICTS
 MAP C

DESIGNATED HAMLET OF
 WRENTHAM - FRINGE

LAND USE DISTRICTS
 Bylaw No: 930-17
 October 24, 2017
 Amending Bylaw 980-22

-  EXTENSIVE AGRICULTURE (AG)
-  URBAN FRINGE (UF)
-  HAMLET COMMERCIAL (HC)
-  HAMLET INDUSTRIAL (HI)
-  HAMLET PUBLIC/INSTITUTIONAL (HP/I)
-  HAMLET RESIDENTIAL (HR)
-  HAMLET TRANSITIONAL/AGRICULTURAL (HT/A)
-  LINEAR PARCEL DIRECT CONTROL (LPDC)
-  HAMLET BOUNDARY

MAP PREPARED BY:
 OLDMAN RIVER REGIONAL SERVICES COMMISSION
 3105 16th AVENUE NORTH, LETSBIDGE, ALBERTA T1H 5E8
 TEL. 403-329-1344
 NOT RESPONSIBLE FOR ERRORS OR OMISSIONS

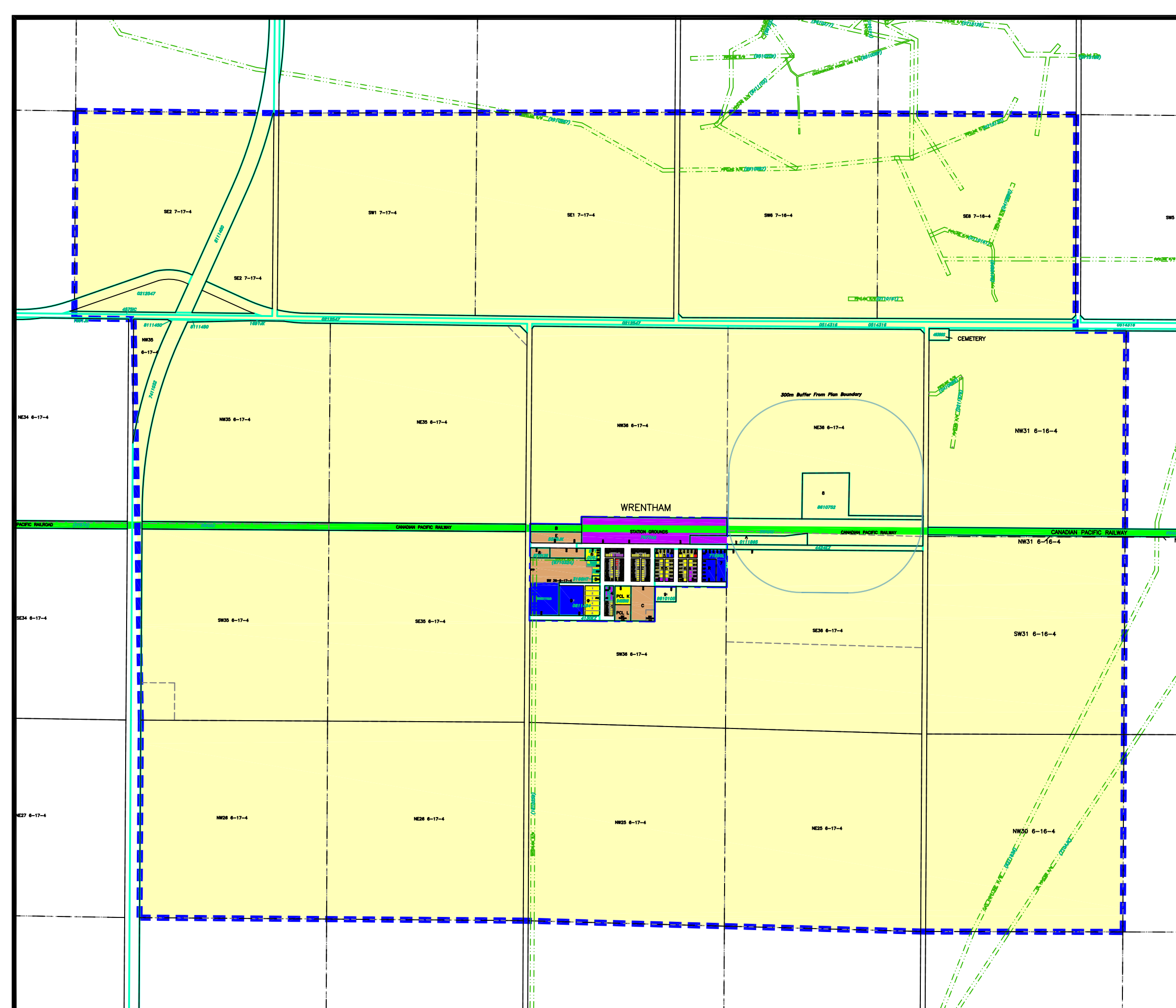

COUNTY OF WARNER NO. 5
 LAND USE DISTRICTS
 MAP C

DESIGNATED HAMLET OF
 WRENTHAM

WRENTHAM

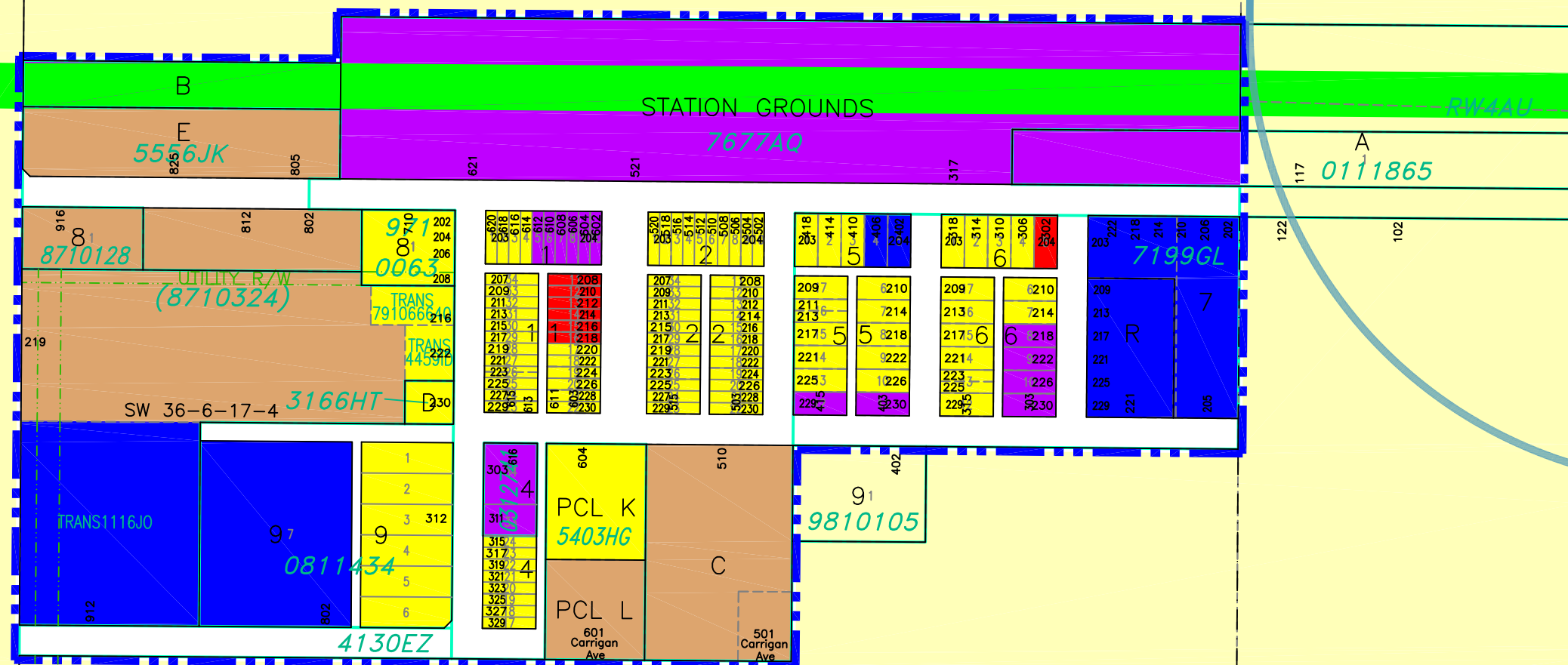

LAND USE DISTRICTS
 Bylaw No: 930-17
 October 24, 2017
 Amending Bylaw 980-22

- EXTENSIVE AGRICULTURE (AG)
- URBAN FRINGE (UF)
- HAMLET COMMERCIAL (HC)
- HAMLET INDUSTRIAL (HI)
- HAMLET PUBLIC/INSTITUTIONAL (HP/I)
- HAMLET RESIDENTIAL (HR)
- HAMLET TRANSITIONAL/AGRICULTURAL (HT/A)
- LINEAR PARCEL DIRECT CONTROL (LPDC)
- HAMLET BOUNDARY

SW36 6-17-4

MAP PREPARED BY:
 OLDMAN RIVER REGIONAL SERVICES COMMISSION
 3105 16th AVENUE NORTH, LETHBRIDGE, ALBERTA T1H 5E8
 TEL. 403-329-1344
 NOT RESPONSIBLE FOR ERRORS OR OMISSIONS









COUNTY OF WARNER NO. 5
LAND USE DISTRICTS
MAP D

TOWN OF RAYMOND
FRINGE

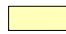
RAYMOND

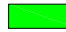
LAND USE DISTRICTS
Bylaw No: 930-17
October 24, 2017

-  EXTENSIVE AGRICULTURE (AG)
-  GROUPED COUNTRY RESIDENTIAL (GCR)
-  URBAN FRINGE (UF)
-  URBAN FRINGE INDUSTRIAL (UFI)
-  LINEAR PARCEL DIRECT CONTROL (LPDC)
-  URBAN FRINGE BOUNDARY

MAP PREPARED BY:
OLDMAN RIVER REGIONAL SERVICES COMMISSION
3105 16th AVENUE NORTH, LETHBRIDGE, ALBERTA T1H 5E8
TEL: 403-329-1244
"NOT RESPONSIBLE FOR ERRORS OR OMISSIONS"







July 25, 2024 N:\Warner-County\Warner-County LUD & Land Use Redesignators\Warner County LUB 930-17 October 24 2017 (Maps amended To Bylaw 930-24).dwg

COUNTY OF WARNER NO. 5
LAND USE DISTRICTS
MAP E

VILLAGE OF STIRLING
FRINGE

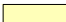
STIRLING

LAND USE DISTRICTS
Bylaw No: 930-17
October 24, 2017

-  EXTENSIVE AGRICULTURE (AG)
-  URBAN FRINGE (UF)
-  URBAN FRINGE AGRICULTURAL (UFA)
-  URBAN FRINGE RESIDENTIAL (UFR)
-  LINEAR PARCEL DIRECT CONTROL (LPDC)
-  URBAN FRINGE BOUNDARY



MAP PREPARED BY:
OLDMAN RIVER REGIONAL SERVICES COMMISSION
3105 16th AVENUE NORTH, LETHBRIDGE, ALBERTA T1H 5E8
TEL: 403-329-1344
NOT RESPONSIBLE FOR ERRORS OR OMISSIONS



COUNTY OF WARNER NO. 5
LAND USE DISTRICTS
MAP F

TOWN OF MILK RIVER
FRINGE

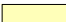
LAND USE DISTRICTS
Bylaw No: 930-17
October 24, 2017

-  EXTENSIVE AGRICULTURE (AG)
-  URBAN FRINGE (UF)
-  LINEAR PARCEL DIRECT CONTROL (LPDC)
-  URBAN FRINGE BOUNDARY

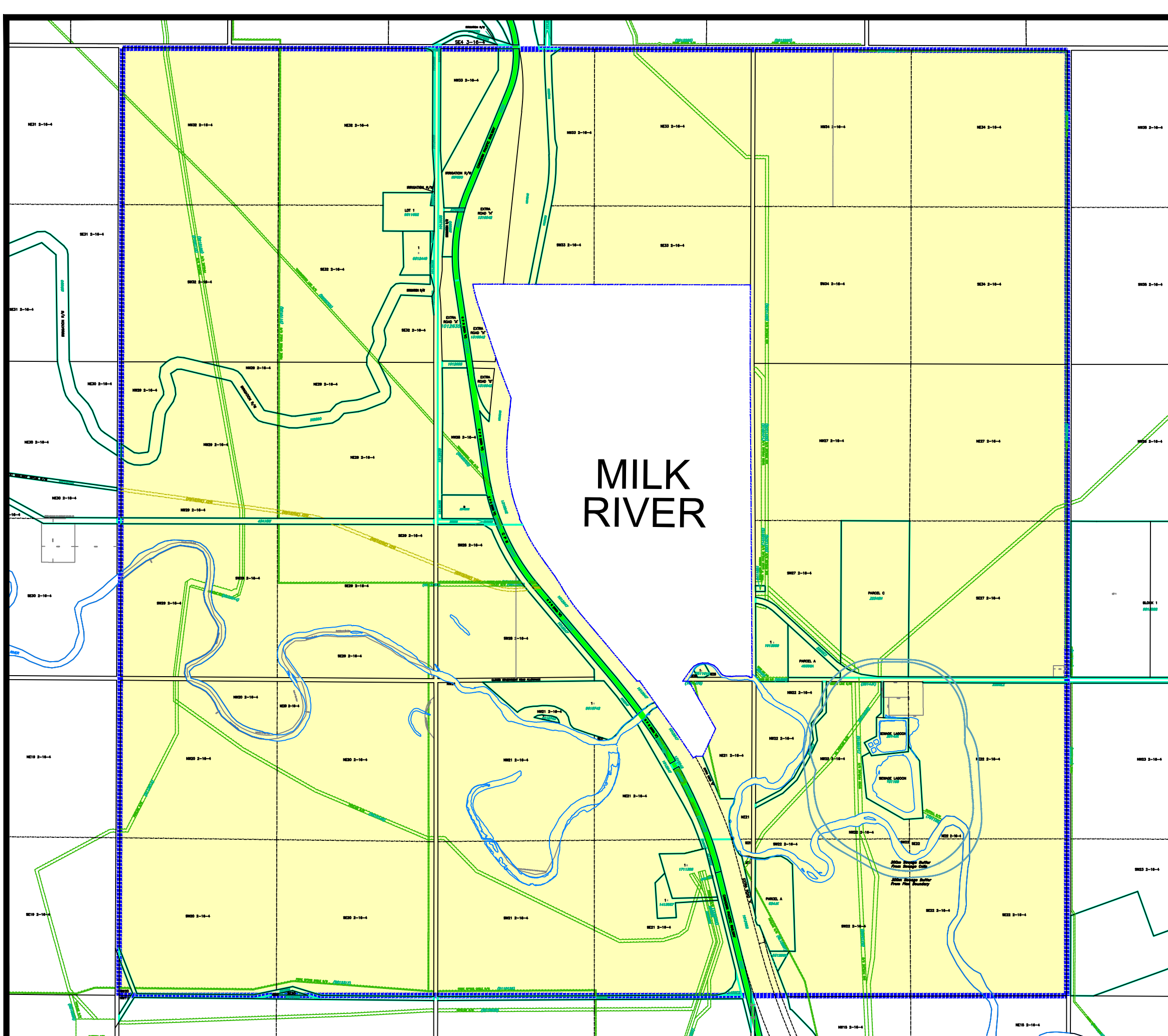

MAP PREPARED BY:
OLDMAN RIVER REGIONAL SERVICES COMMISSION
3105 16th AVENUE NORTH, LETHBRIDGE, ALBERTA T1H 5G8
TEL: 403-329-1344
NOT RESPONSIBLE FOR ERRORS OR OMISSIONS



November 08, 2017 \\N:\Warner-County\Warner-County LUD & Land Use Reorganization\Warner County LUD 930-17 October 24 2017 (Maps)\02

COUNTY OF WARNER NO. 5
LAND USE DISTRICTS
MAP G

VILLAGE OF WARNER
FRINGE

LAND USE DISTRICTS
Bylaw No: 930-17
October 24, 2017

- EXTENSIVE AGRICULTURE (AG)
- URBAN FRINGE (UF)
- LINEAR PARCEL DIRECT CONTROL (LPDC)
- URBAN FRINGE BOUNDARY

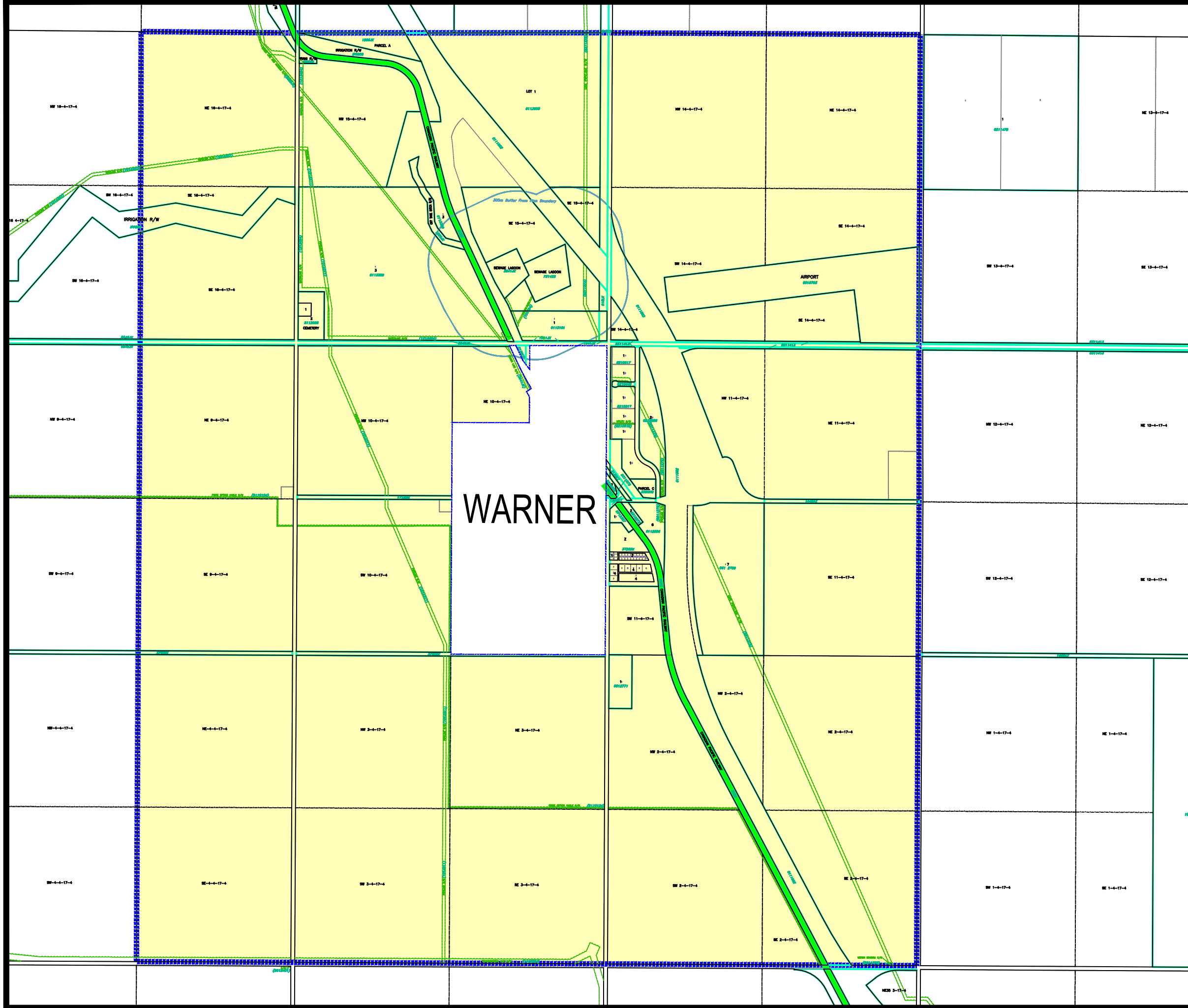



MAP PREPARED BY:
OLDMAN RIVER REGIONAL SERVICES COMMISSION
3105 16th AVENUE NORTH, LETHBRIDGE, ALBERTA T1H 5E8
TEL: 403-329-1344
NOT RESPONSIBLE FOR ERRORS OR OMISSIONS



COUNTY OF WARNER NO. 5
 LAND USE DISTRICTS
 MAP H

VILLAGE OF COUTTS
 FRINGE

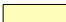
LAND USE DISTRICTS
 Bylaw No: 930-17
 October 24, 2017

-  EXTENSIVE AGRICULTURE (AG)
-  URBAN FRINGE (UF)
-  LINEAR PARCEL DIRECT CONTROL (LPDC)
-  URBAN FRINGE BOUNDARY

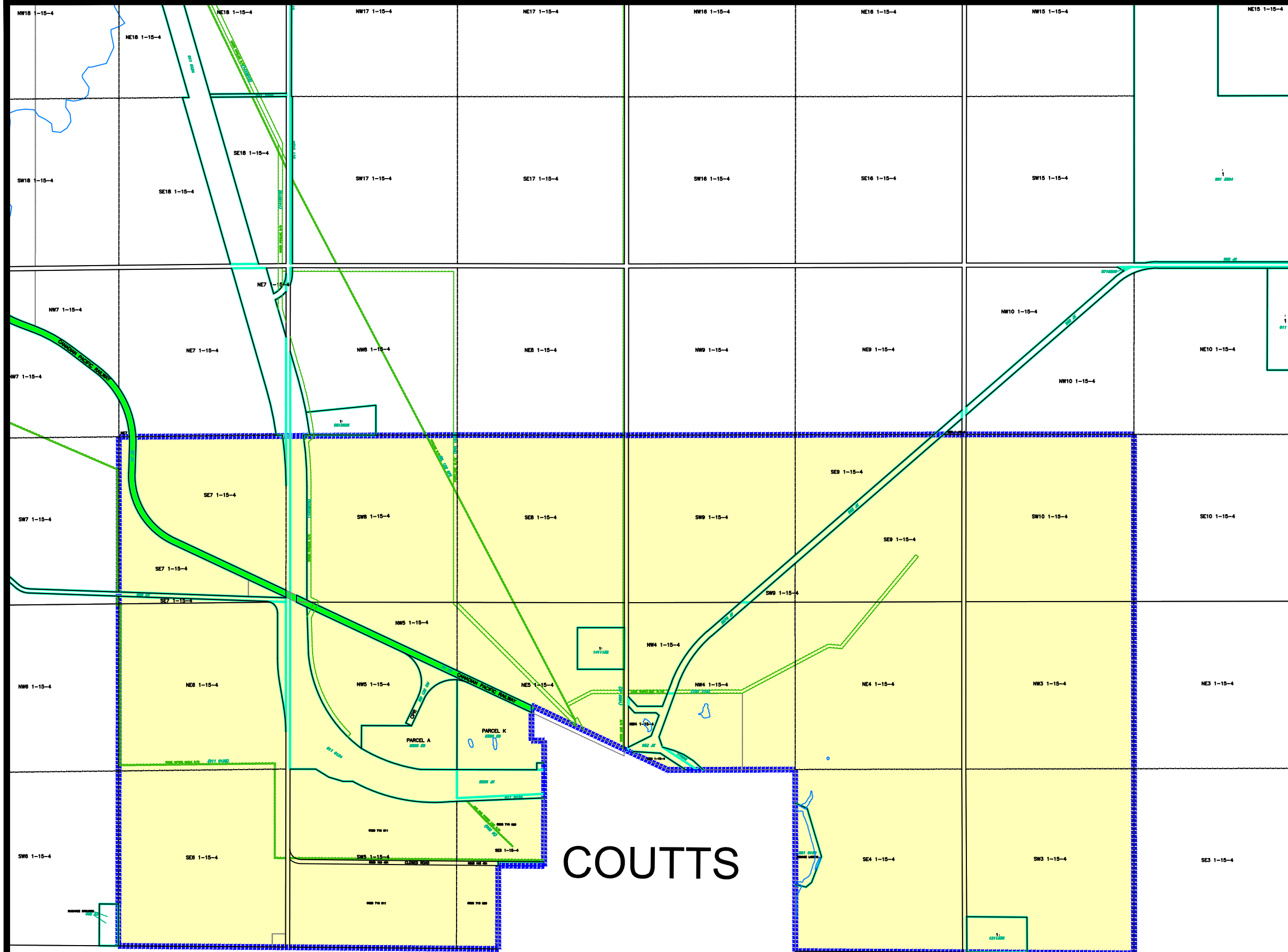

MAP PREPARED BY:
 OLDMAN RIVER REGIONAL SERVICES COMMISSION
 3105 16th AVENUE NORTH, LETHBRIDGE, ALBERTA T1V 5E9
 TEL: 403-329-1344
 NOT RESPONSIBLE FOR ERRORS OR OMISSIONS





November 08, 2017 N:\Warner-County\Warner-County LUO & Land Use Reorganization\Warner County LUO 930-17 October 24 2017 (Maps)\00

COUNTY OF WARNER NO. 5
LAND USE DISTRICTS
MAP 1

Lot 2, Block 1, Plan 0513604, &
Lots 3 & 4, Block 1, Plan 0614487 In
SE 1/4 SEC 1, TWP 7, RGE 21, W4M

LAND USE DISTRICTS
Bylaw No: 930-17
October 24, 2017

-  GROUPED COUNTY RESIDENTIAL (GCR)
-  EXTENSIVE AGRICULTURE (AG)

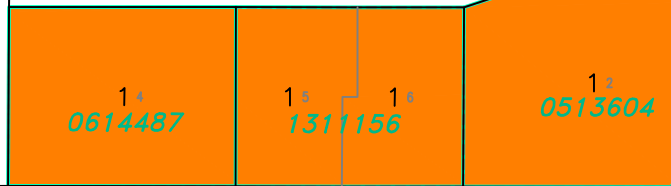

PIPELINE R/W (0112189)

SE1 7-21-4

CANAL R/W
3651HX

IRRIGATION R/W

SE1 7-21-4

8610433



MAP PREPARED BY:
OLDMAN RIVER REGIONAL SERVICES COMMISSION
3105 10th AVENUE NORTH, LETHBRIDGE, ALBERTA T1M 0S2
TEL: 403-329-1344
"NOT RESPONSIBLE FOR ERRORS OR OMISSIONS"



COUNTY OF WARNER NO. 5
LAND USE DISTRICTS
MAP 2

PORTION OF
SW 1/4 SEC 36, TWP 6, RGE 21, W4M
& Lots 1, 2 & 3, Block 2, Plan 0712599

LAND USE DISTRICTS
Bylaw No: 930-17
October 24, 2017

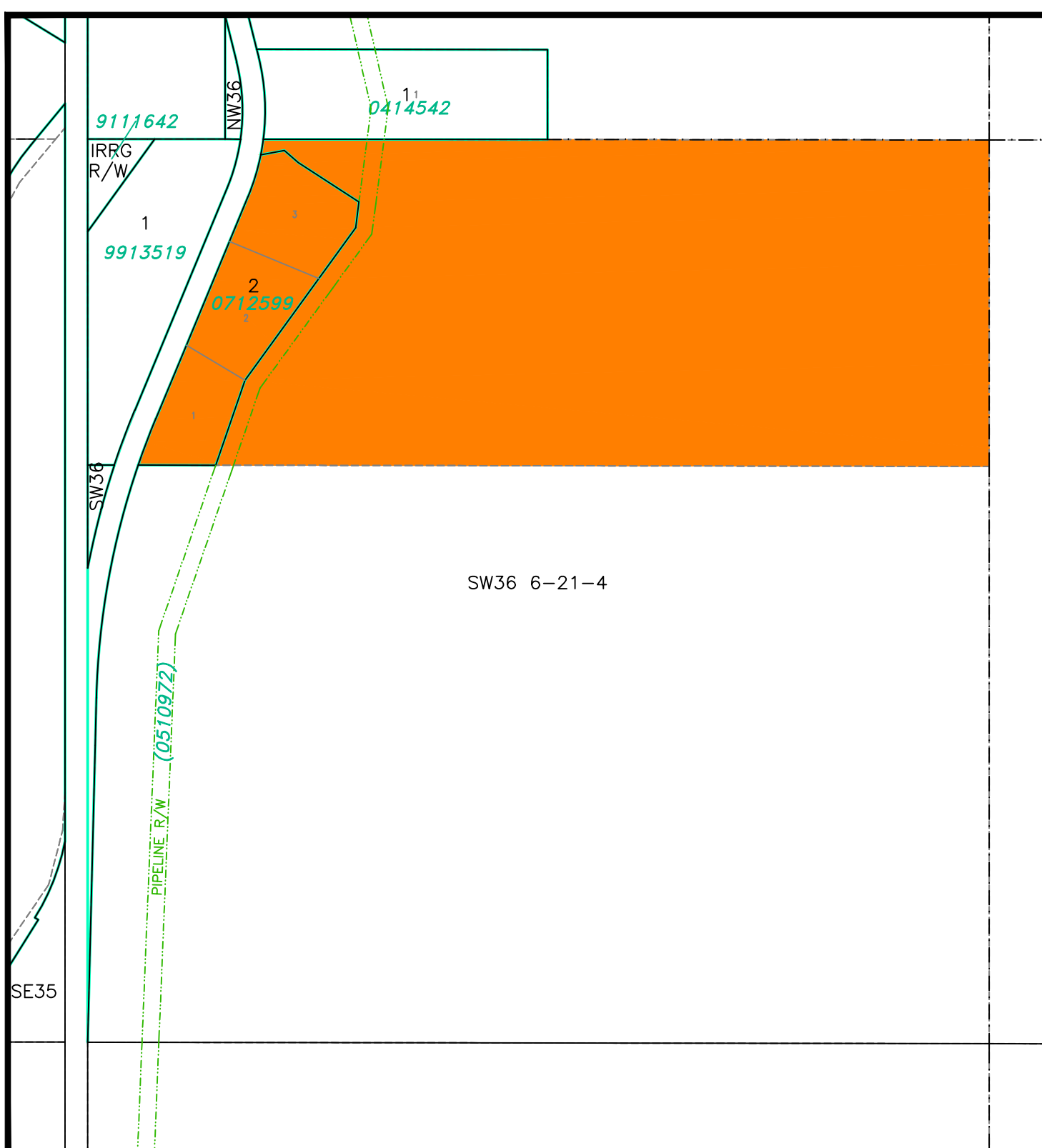

-  GROUPED COUNTY RESIDENTIAL (GCR)
-  EXTENSIVE AGRICULTURE (AG)



COUNTY OF WARNER NO. 5
 LAND USE DISTRICTS
 MAP 3

Lots 4 To 7, Block 4, Plan 0715123,
 Lots 8 to 10, Block 4, Plan 0912838 and
 Lot 69 and Portions of
 Lots 68 & 70, Plan 1345J in
 NW 1/4 SEC 11, TWP 6, RGE 21, W4M
 Lots 1 to 5, Block 2, Plan 0811109 In
 SW 1/4 SEC 14, TWP 6, RGE 21, W4M

LAND USE DISTRICTS
 Bylaw No: 930-17
 October 24, 2017

-  GROUPED COUNTY RESIDENTIAL (GCR)
-  EXTENSIVE AGRICULTURE (AG)

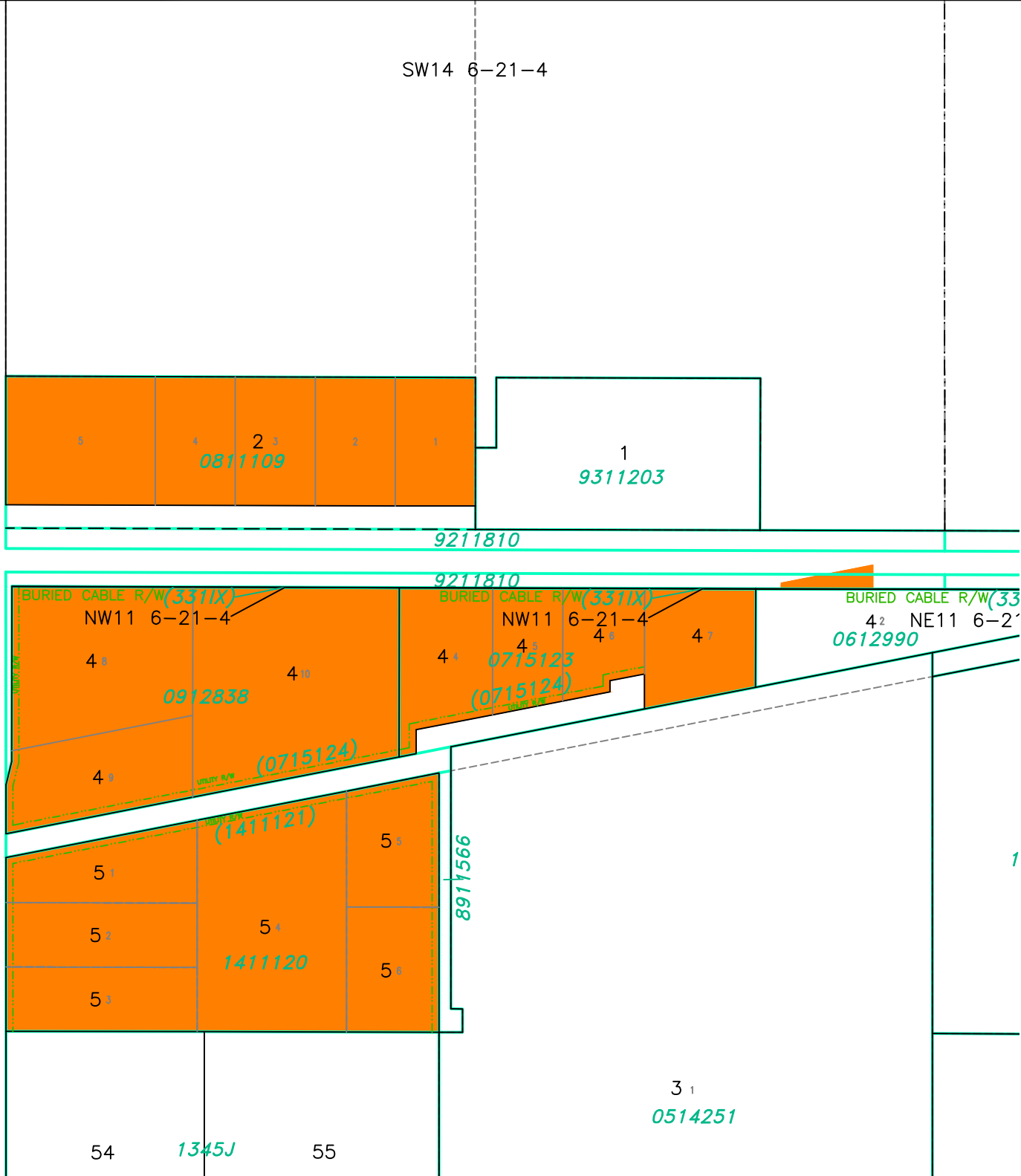

COUNTY OF WARNER NO. 5
 LAND USE DISTRICTS
 MAP 4

Block 1, Plan 9610970 &
 Lots 1 to 5, Block 2, Plan 0714201 In
 NE 1/4 SEC 27, TWP 5, RGE 20, W4M
 & SE 1/4 SEC 27, TWP 5, RGE 20, W4M

LAND USE DISTRICTS
 Bylaw No: 930-17
 October 24, 2017
 Amending Bylaw 940-18

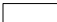

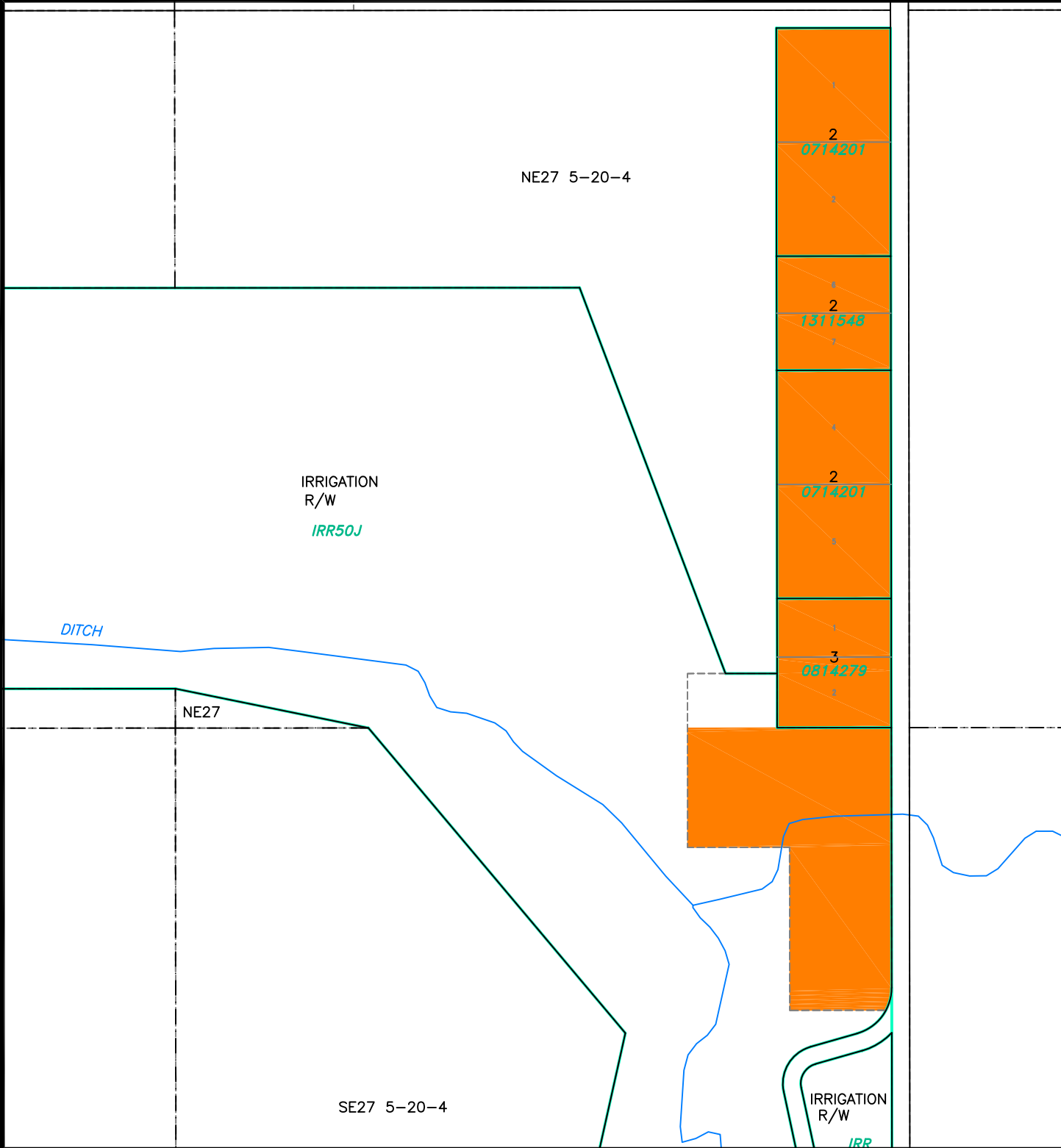
-  GROUPED COUNTY RESIDENTIAL (GCR)
-  EXTENSIVE AGRICULTURE (AG)



COUNTY OF WARNER NO. 5
 LAND USE DISTRICTS
 MAP 5

Lots 1 To 6, Block 1, Plan 0812901 &
 Portion Of
 SE 1/4 SEC 27, TWP 6, RGE 21, W4M

LAND USE DISTRICTS
 Bylaw No: 930-17
 October 24, 2017

-  GROUPED COUNTY RESIDENTIAL (GCR)
-  EXTENSIVE AGRICULTURE (AG)

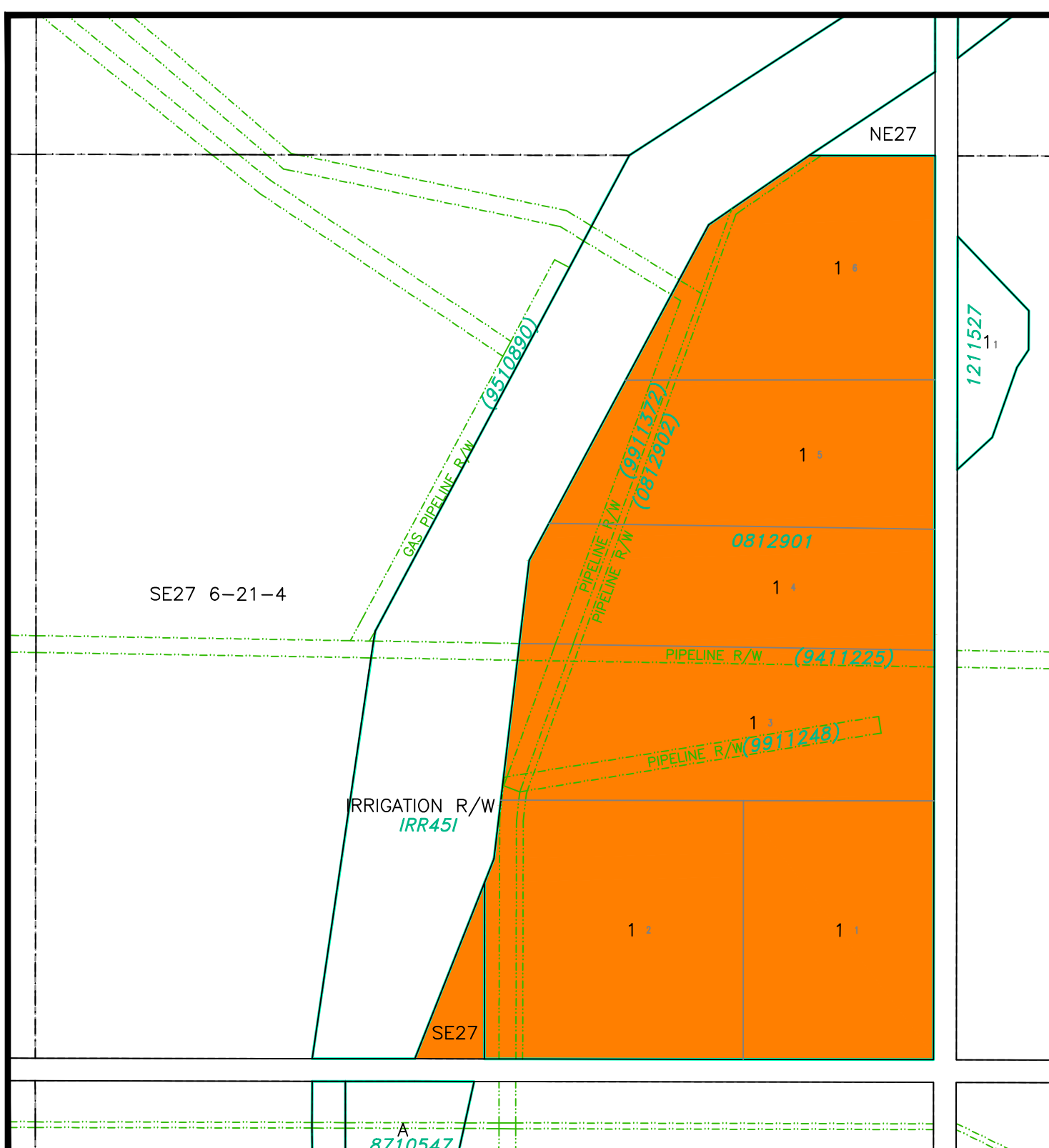

COUNTY OF WARNER NO. 5
 LAND USE DISTRICTS
 MAP 6

PORTION OF
 SW 1/4 SEC 14, TWP 6, RGE 20, W4M

SW14 6-20-4

CANAL R/W

SW14 6-20-4

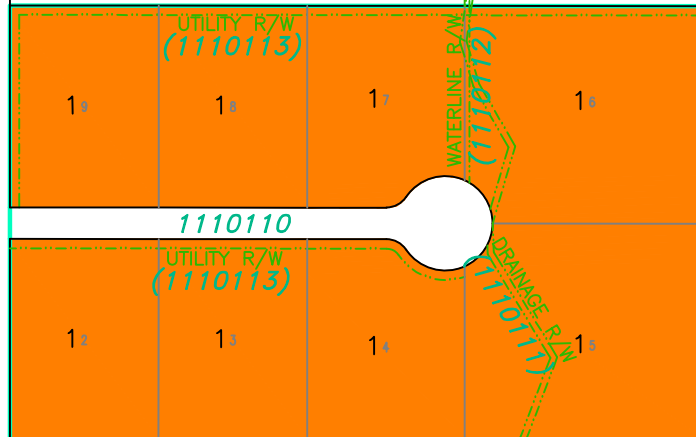

LAND USE DISTRICTS
 Bylaw No: 930-17
 October 24, 2017

- GROUPED COUNTY RESIDENTIAL (GCR)
- EXTENSIVE AGRICULTURE (AG)



5527HX

COUNTY OF WARNER NO. 5
LAND USE DISTRICTS
MAP 7

PORTION OF
SE 1/4 SEC 3, TWP 7, RGE 20, W4M

SE3 7-20-4

LAND USE DISTRICTS
Bylaw No: 930-17
October 24, 2017

-  GROUPED COUNTY RESIDENTIAL (GCR)
-  EXTENSIVE AGRICULTURE (AG)

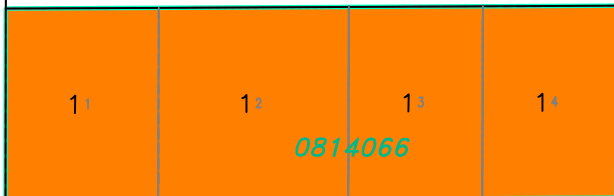

COUNTY OF WARNER NO. 5
LAND USE DISTRICTS
MAP 8

Lots 2 To 6, Block 1, Plan 0511192 In
Portion Of SEC 5, TWP 7, RGE 19, W4M

LAND USE DISTRICTS
Bylaw No: 930-17
October 24, 2017

- GROUPED COUNTY RESIDENTIAL (GCR)
- EXTENSIVE AGRICULTURE (AG)
- URBAN FRINGE (UF)
- LINEAR PARCEL DIRECT CONTROL (LPDC)
- URBAN FRINGE BOUNDARY

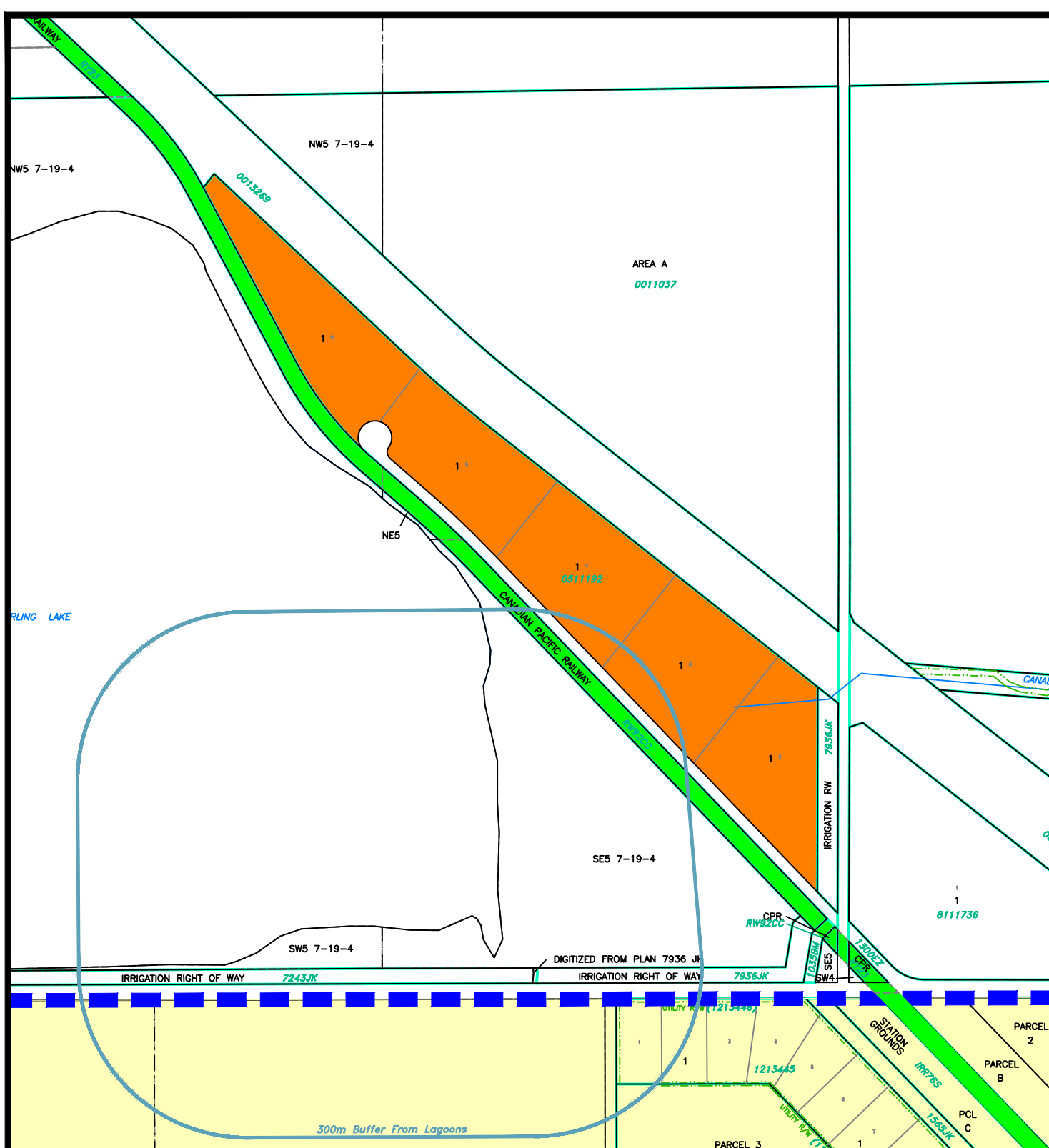

MAP PREPARED BY:
OLDMAN RIVER REGIONAL SERVICES COMMISSION
3105 10th AVENUE WEST/STY LETHBRIDGE, ALBERTA T1A 5G9
TEL. 403-329-1344
"NOT RESPONSIBLE FOR ERRORS OR OMISSIONS"





November 08, 2017 N:\Warner\County\Warner\County Land Use Releaseregions\Warner County LUB 930-17 October 24 2017 08:00:00

COUNTY OF WARNER NO. 5
 LAND USE DISTRICTS
 MAP 9

Portion Of
 N 1/2 SEC 6, TWP 5, RGE 19, W4M

LAND USE DISTRICTS
 Bylaw No: 930-17
 October 24, 2017

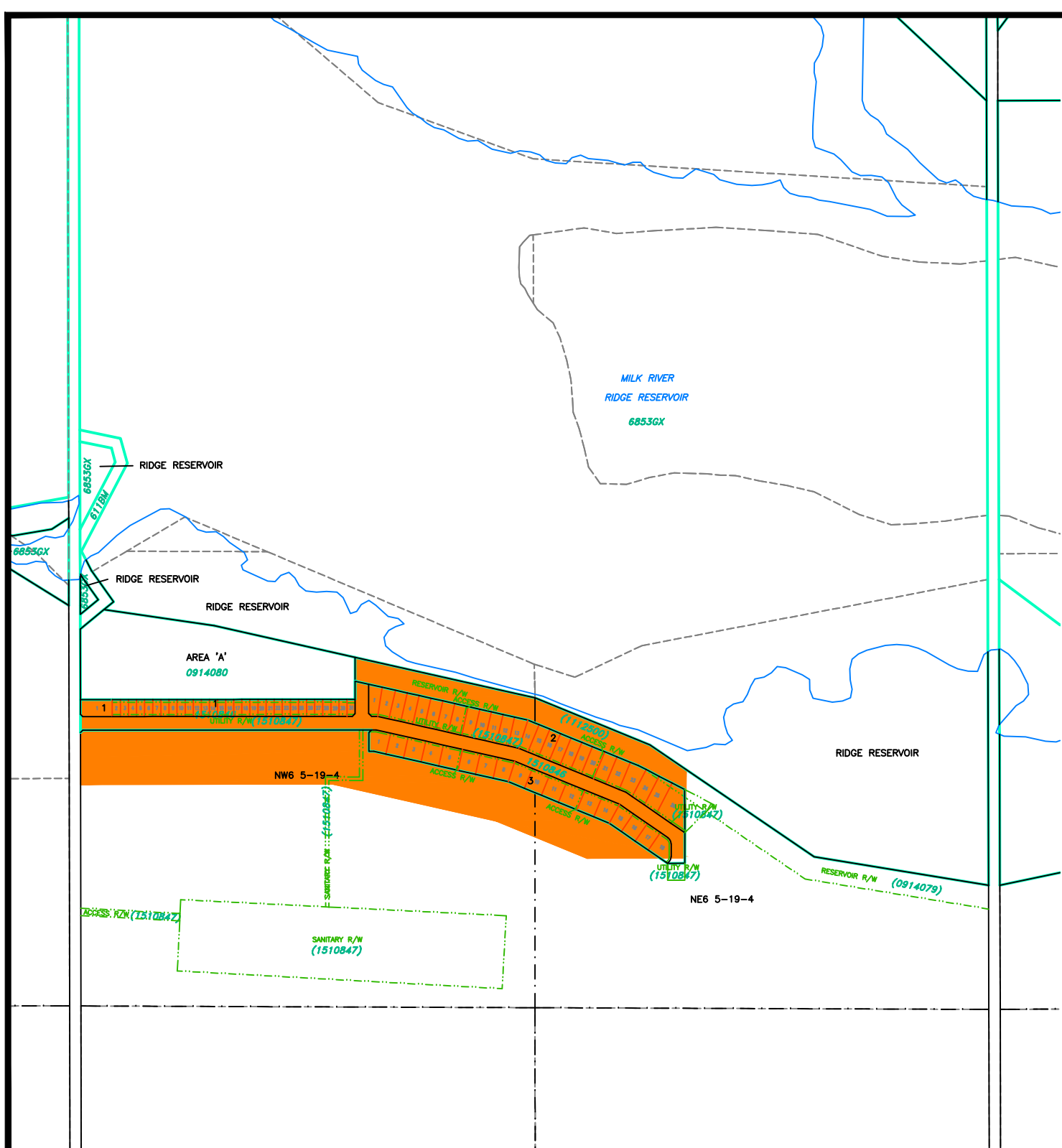

-  GROUPED COUNTY RESIDENTIAL (GCR)
-  EXTENSIVE AGRICULTURE (AG)



COUNTY OF WARNER NO. 5
 LAND USE DISTRICTS
 MAP 10

Portions Of
 LSD's 13, 14, 15 & 16 in the
 NE & NW SEC 25, TWP 7, RGE 17, W 4 M
 & LSD's 3, 4 & 5 in the
 SW SEC 36, TWP 7, RGE 17, W 4 M

LAND USE DISTRICTS
 Bylaw No: 930-17
 October 24, 2017

-  GROUPED COUNTY RESIDENTIAL (GCR)
-  EXTENSIVE AGRICULTURE (AG)

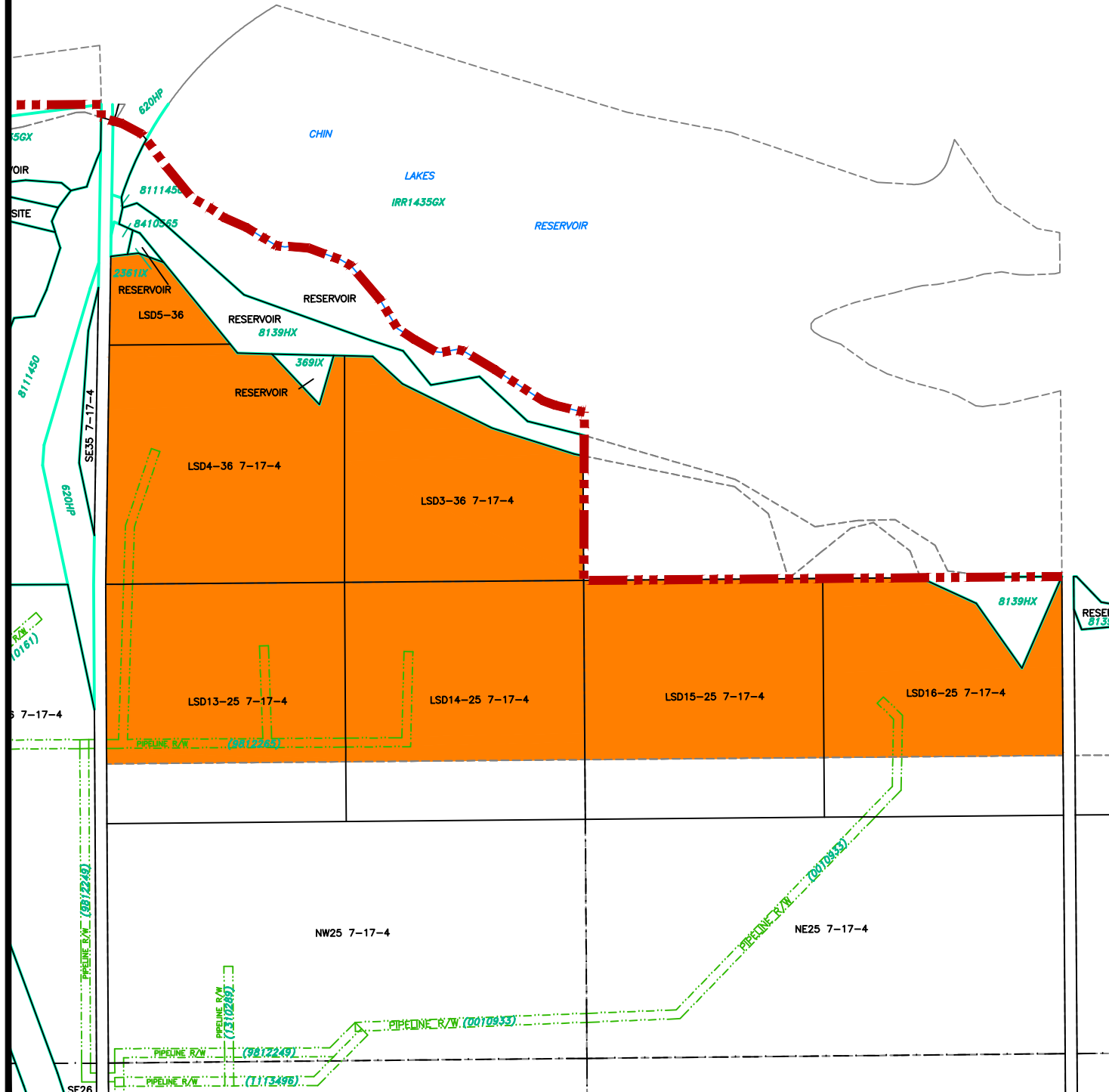



MAP PREPARED BY:
 OLDMAN RIVER REGIONAL SERVICES COMMISSION
 3105 106 AVENUE WEST/11 LETHBRIDGE, ALBERTA T1V 5G9
 TEL: 403-329-1344
 NOT RESPONSIBLE FOR ERRORS OR OMISSIONS



COUNTY OF WARNER NO. 5
LAND USE DISTRICTS
MAP 11

Portion Of
SE 1/4 SEC 17, TWP 5, RGE 20, W4M

LAND USE DISTRICTS
Bylaw No: 930-17
October 24, 2017

-  GROUPED COUNTY RESIDENTIAL (GCR)
-  EXTENSIVE AGRICULTURE (AG)

RESERVOIR

SE17 5-20-4

RESERVOIR

3549AZ
6853GX

RIVER RIDGE RESERVOIR
6853GX

RESERVOIR
6853GX

1510635



3549AZ

3549AZ
NE8

COUNTY OF WARNER NO. 5
LAND USE DISTRICTS
MAP 12

Portion Of
SE 1/4 SEC 6, TWP 7, RGE 20, W4M

LAND USE DISTRICTS
Bylaw No: 930-17
October 24, 2017

-  GROUPED COUNTY RESIDENTIAL (GCR)
-  EXTENSIVE AGRICULTURE (AG)

3 4
1412011

3 2
1312908

1212613

8710453

1
9610

SE6 7-20-4

1

1

1

SE6 7-20-4

COUNTY OF WARNER NO. 5
 LAND USE DISTRICTS
 MAP 13

Lots 4 & 5, Block 1, Plan 9711687 &
 Lot 61, Plan 1345J in
 NE 1/4 SEC 11, TWP 6, RGE 21, W 4 M

LAND USE DISTRICTS
 Bylaw No: 930-17
 October 24, 2017

- GROUPED COUNTY RESIDENTIAL (GCR)
- EXTENSIVE AGRICULTURE (AG)
- URBAN FRINGE (UF)

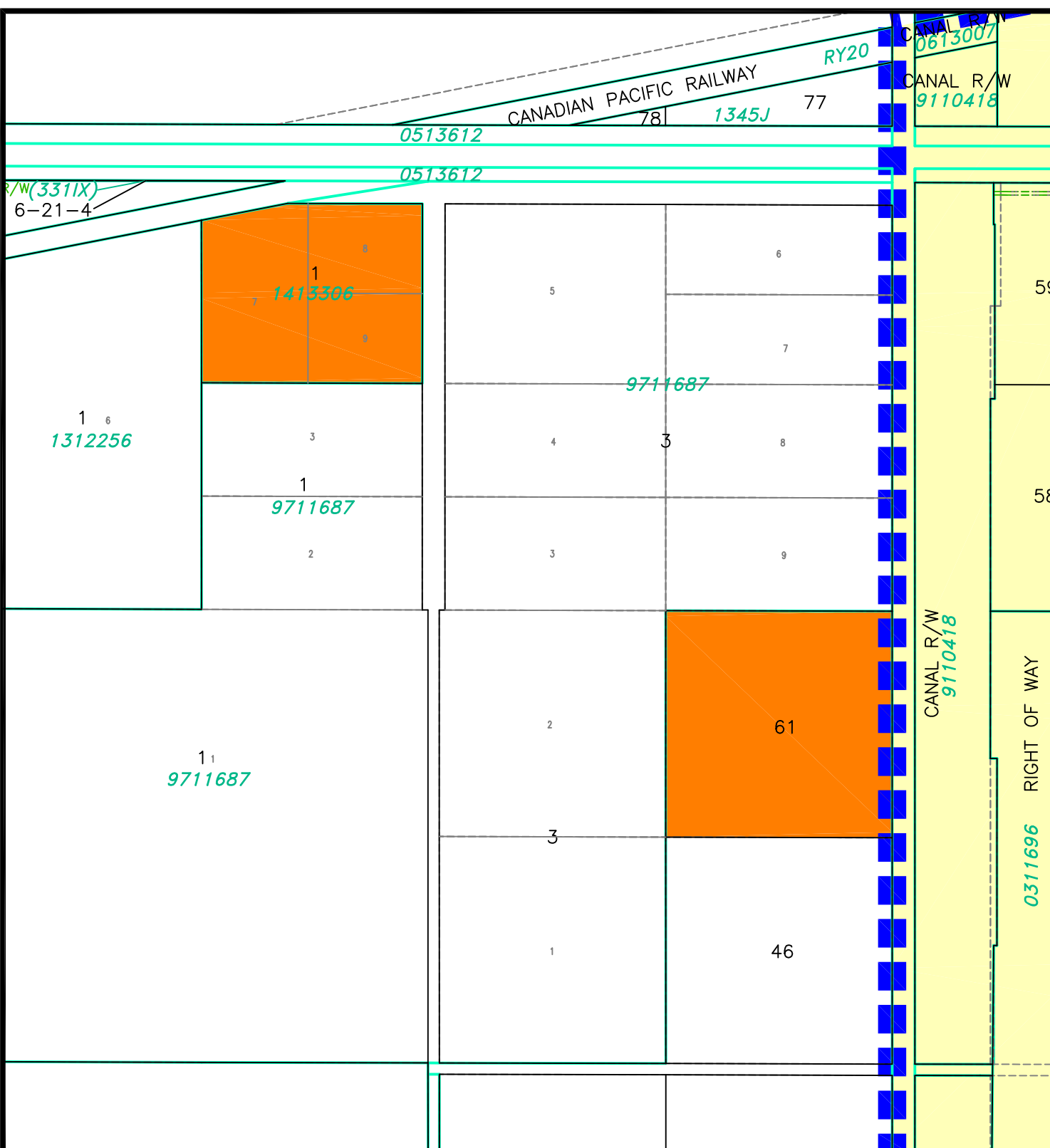

MAP PREPARED BY:
 OLDMAN RIVER REGIONAL SERVICES COMMISSION
 3105 18th AVENUE NORTH, LETHBRIDGE, ALBERTA T1H 5E8
 TEL: 403-329-1344
 "NOT RESPONSIBLE FOR ERRORS OR OMISSIONS"



COUNTY OF WARNER NO. 5
 LAND USE DISTRICTS
 MAP 14

Portion Of
 NW 1/4 SEC 13, TWP 5, RGE 20, W 4 M

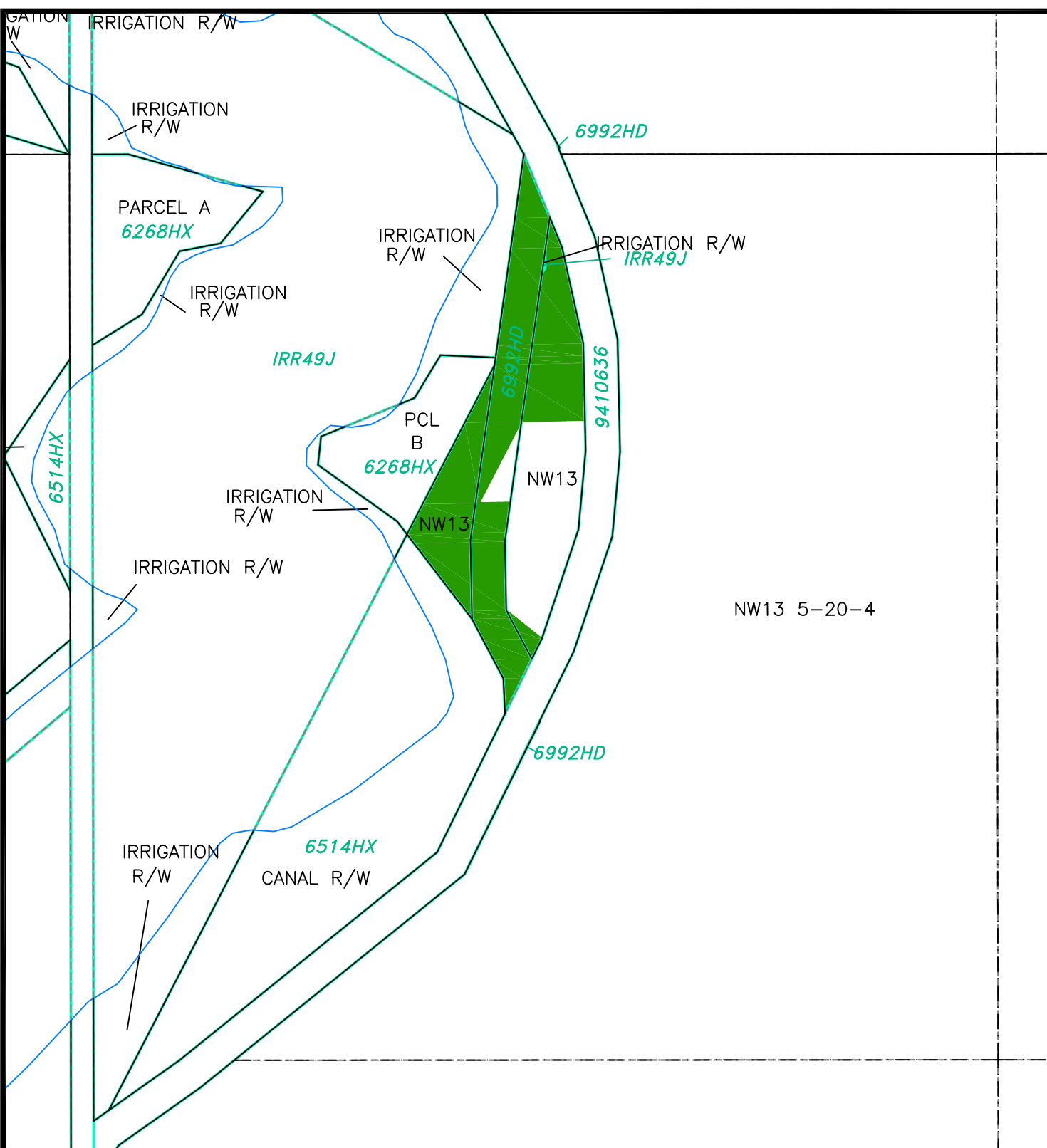

NW13 5-20-4

LAND USE DISTRICTS
 Bylaw No: 930-17
 October 24, 2017
 Amending Bylaw 933-18

- RURAL RECREATIONAL (RR)
- EXTENSIVE AGRICULTURE (AG)

COUNTY OF WARNER NO. 5
LAND USE DISTRICTS
MAP 15

Lot 1, Block 2, Plan 0110579 within
SE 1/4 SEC 29, TWP 6, RGE 20, W4M

SE29 6-20-4

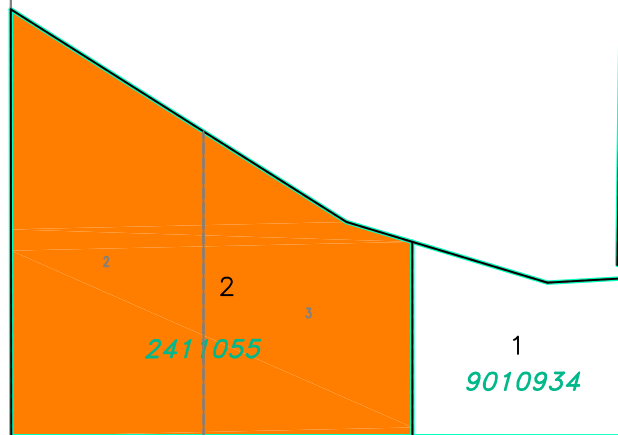

2411055

1
9010934

LAND USE DISTRICTS

Bylaw No: 930-17

October 24, 2017

Amending Bylaw 988-23

 GROUPED COUNTY RESIDENTIAL (GCR)

 EXTENSIVE AGRICULTURE (AG)

MAP PREPARED BY:
OLDMAN RIVER REGIONAL SERVICES COMMISSION
3105 188 AVENUE NORTH, LETHBRIDGE, ALBERTA T1H 5E8
TEL: 403-329-1344
NOT RESPONSIBLE FOR ERRORS OR OMISSIONS



September 05, 2024 \\N:\Name=County\Warner\County LUD & Land Use Redesign\Warner County LUD 930-17 October 24 2017 (Map amended To Bylaw 988-23).img

COUNTY OF WARNER NO. 5
LAND USE DISTRICTS
MAP 16

Lot 27, Plan 1345J within
SE 1/4 SEC 11, TWP 6, RGE 21, W4M

21
9711695

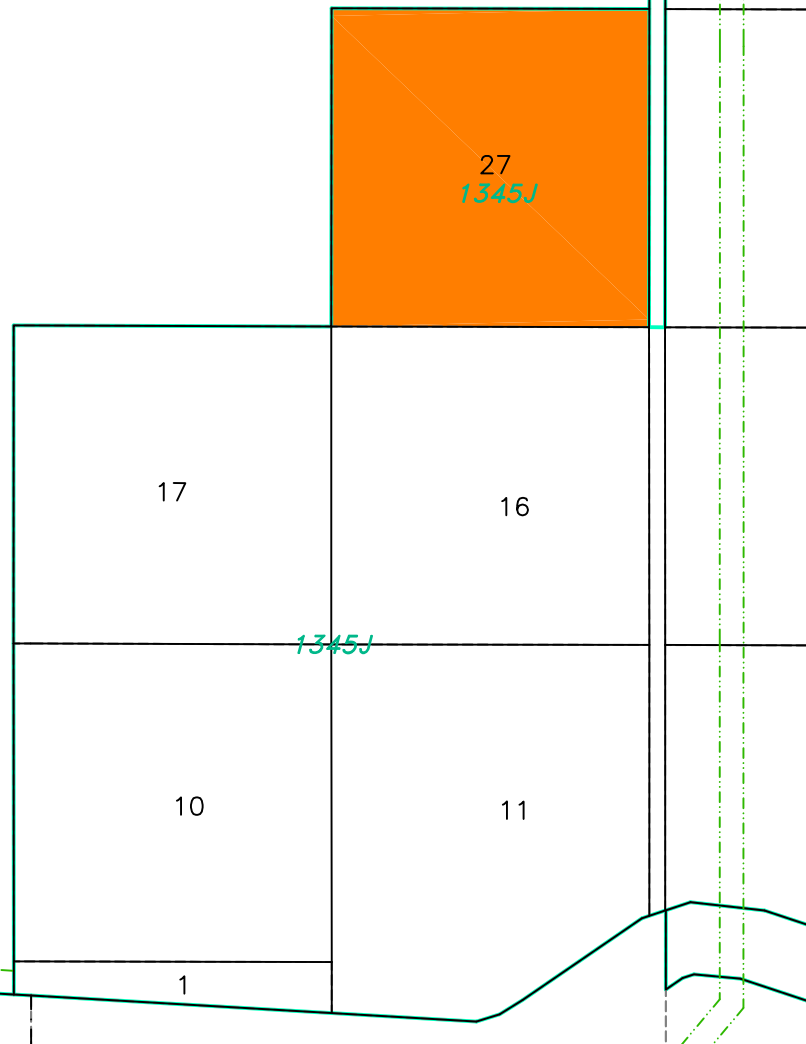

LAND USE DISTRICTS

Bylaw No: 930-17

October 24, 2017

Amending Bylaw 989-24

 GROUPED COUNTY RESIDENTIAL (GCR)

 EXTENSIVE AGRICULTURE (AG)

MAP PREPARED BY:
OLDMAN RIVER REGIONAL SERVICES COMMISSION
3105 188 AVENUE NORTH, LETHBRIDGE, ALBERTA T1H 5E8
TEL: 403-329-1344
NOT RESPONSIBLE FOR ERRORS OR OMISSIONS



September 05, 2024 \\NetName=County\Warner\County LUD & Land Use Redesign\Warner County LUD 930-17 October 24 2017 (Map amended To Bylaw 989-24).img